

# SELF-PRIMING MULTISTAGE CENTRIFUGAL PUMPS

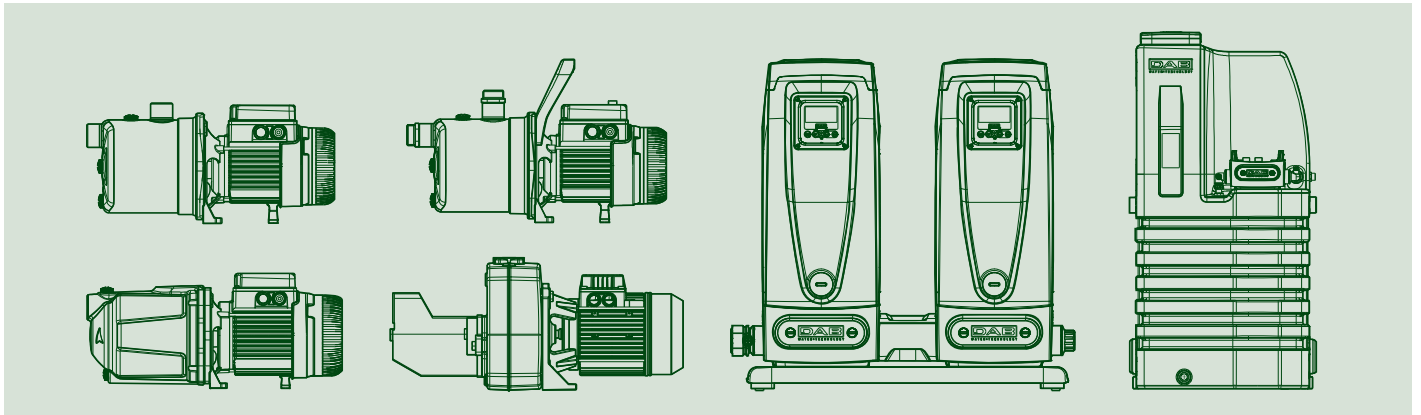

**TECHNICAL  
CATALOGUE**

# AQUAPROF

## PLANTS FOR USE OF RAINWATER



### TECHNICAL DATA

**Max flow rate (lt/min-m<sup>3</sup>/h):** 85-5.1  
**Max head:** 48 m  
**Max. Liquid temperature:** From +5°C to +35°C  
**Max. system pressure:** Max 6 bar  
**Max. mains pressure:** Max 4 bar  
**Minimum mains flow rate:** Min 10 lt/min  
**Maximum height of the highest point of use:** 12 m  
**Power supply:** Volt 230 Hz50  
**Maximum power absorbed:** W 1000  
**Protection rating:** IP 42  
**Ambient temperature:** Min +5°C Max +40°C  
**Cabinet materials:** PPE  
**Tank materials** PE  
**Mains inlet pipe dimensions:** 3/4"  
**Discharge pipe dimensions:** 1"  
**Suction pipe dimensions:** 1"  
**Overflow pipe dimensions:** DN 50  
**Max Altitude:** 1000 metres  
**Max power Pump No. 2 relay:** 3'A\_250Volt  
**Water type:** ph 4-9  
**ON/OFF float version:** ON/OFF float with 20 metre cable  
**version with electronic transducer water level indicator:** electronic transducer (4-20 mA 8-28 V DC) w/20 metres of cable  
**Dry weight in Kg:** 20  
**Operational weight in Kg:** 35

### APPLICATIONS

The AQUAPROF unit is used for rainwater management and distribution. The unit detects any faults in the water collection system, whether from rainwater or the mains and makes corrections to ensure proper operation of the plant (that is, it does not ever leave the connected utilities dry). It signals any faults and displays the problem detected. Generally, this system is reserved for irrigation, clothes washing, WC flushing and floor cleaning applications. The primary purpose of the AQUAPROF system is to give use of the rainwater priority over the use of the mains water. When there is not enough rainwater in the collection tank, the control unit switches over to the mains, ensuring that the connected use points are supplied (PLEASE, NOTE the water supplied by this system is not potable). The connection between the rainwater collection tank and the mains water collection tank in this system is selected by way of a three-way valve installed on the suction side of the pump. Pump operation is precisely that of a "start-stop" system with pressure and flow control. When the pressure drops below a certain threshold level, the pump starts up. Upon closing the tap, the pump stops. If the water runs out, the pump stops and signals a fault on the pump control panel. After a set time, the pump starts back up again automatically. If all the functions' parameters have returned to normal, then the system runs normally. The system is also equipped with a special anti-odour anti-emptying siphon. Every 24 hours, the system checks the operation of the 3-way valves. Every week, the system completely changes the water contained in the mains water collection tank (the change is restricted by the user's water use requirements).

### TECHNICAL SPECIFICATIONS

The system comprises a polypropylene (PPE) foam console and either a EUROINOX 30/50M or a EUROINOX 40/50M electric centrifugal pump. The kit also includes a wall mount bracket and a water level sensor with 20 metres of cable for the AQUAPROF BASIC model ON/OFF version. While for the AQUAPROF TOP version there is an electronic transducer (with a 5 m full scale 4-20 mA 8-28 VDC). With tanks that are less than 2 metres deep, it is suggested that a dedicated sensore with a 2 - 2.5 metre resolution be purchased separately.

# AQUAPROF

## PLANTS FOR USE OF RAINWATER

### PERFORMANCE RANGE

The performance curves are based on kinematic viscosity values = 1 mm<sup>2</sup>/s and density equivalent to 1000 kg/m<sup>3</sup>. Curve tolerance according to ISO 9906.

### GRAPHIC SELECTION TABLE

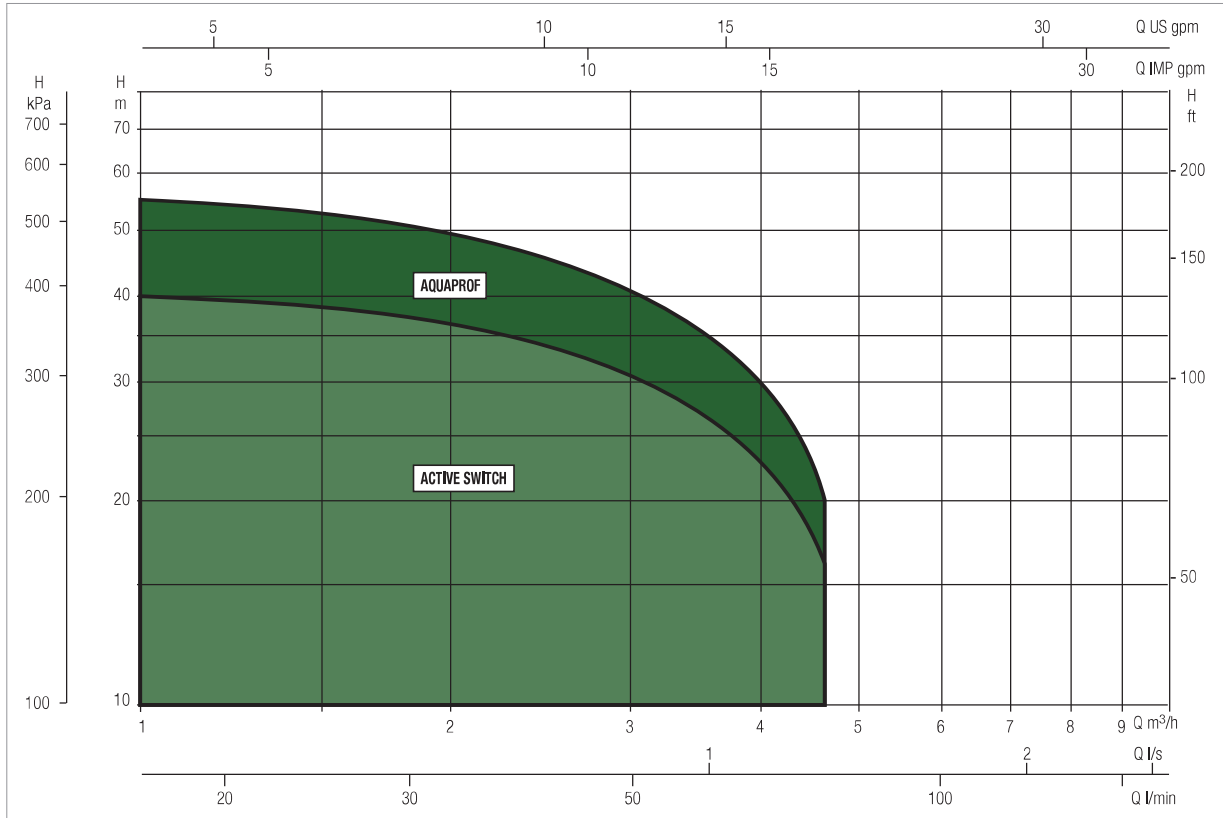

### AQUAPROF SELECTION TABLE

MODEL	Q=m <sup>3</sup> /h	0	0,6	1,2	1,8	2,4	3,0	3,3	3,6	4,2	4,8
	Q=l/min	0	10	20	30	40	50	55	60	70	80
AQUAPROF BASIC 30/50	H (m)	42,2	40,2	38,2	36,2	33,8	30	27,5	24,8	19,5	14
AQUAPROF BASIC 40/50		57,7	55,3	52,8	50,1	47,1	42,7	39,5	35,8	28	19,2
AQUAPROF TOP 30/50		42,2	40,2	38,2	36,2	33,8	30	27,5	24,8	19,5	14
AQUAPROF TOP 40/50		57,7	55,3	52,8	50,1	47,1	42,7	39,5	35,8	28	19,2

# AQUAPROF

## PLANTS FOR USE OF RAINWATER

SELF-PRIMING AND MULTISTAGE CENTRIFUGAL PUMPS

### MATERIALS

N°	PARTS	MATERIALS
1	MAINS WATER TANK	LLDPE
2	MAINS WATER INLET	METAL HOSE
3	CONTROL PANEL	-
4	3-WAY VALVE	VALVE BODY: BRASS RETURN SPRINGS: STEEL MOTOR COVER: SELF-EXTINGUISHING ABS
5	PUMP	EUROINOX
6	CONTROL SYSTEM HYDRAULIC PUMP	POM / NBR / STEEL
7	ANTI-DRIP EXPANSION TANK	DIAPHRAGM WITH HIGH CHLOROBUTYL CONTENT
8	WARM AIR VENT	-
9	RAINWATER SUCTION	BRASS
10	AIR INTAKE PUMP COOLING	-
11	PRESSURIZED WATER OUTLET	METAL HOSE
12	REAR CLADDING	PP FOAM
13	EMERGENCY OVERFLOW	-
14	PRESSURE GAUGE	-
15	HORIZONTAL OUTLET	BRASS
16	CHANNEL FOR HOSES AND ELECTRIC CABLES	-
17	FLOAT VALVE	PA 66 / STEEL / POLYSTYRENE
18	PUMP LOAD PLUG	PP / O-R IN NBR
19	CHECK VALVE	BRASS

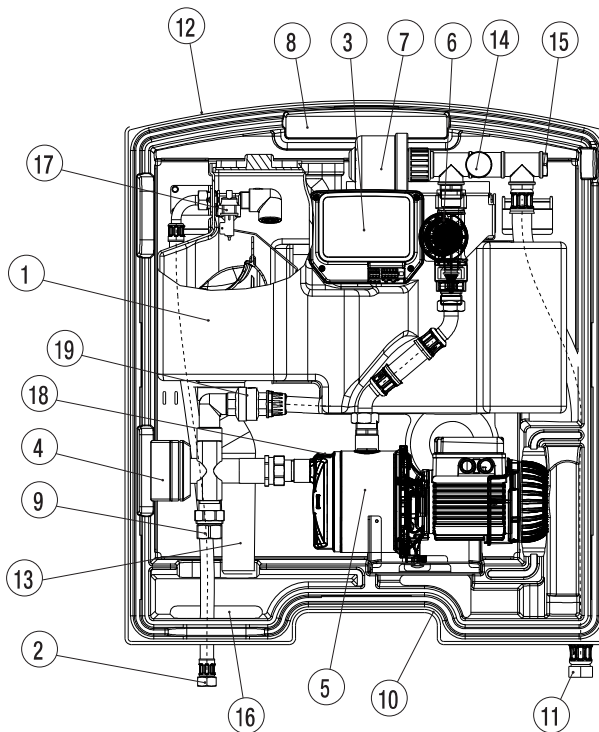

### CONTROL PANEL

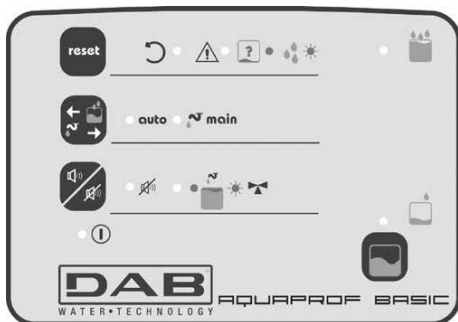

AQUAPROF BASIC

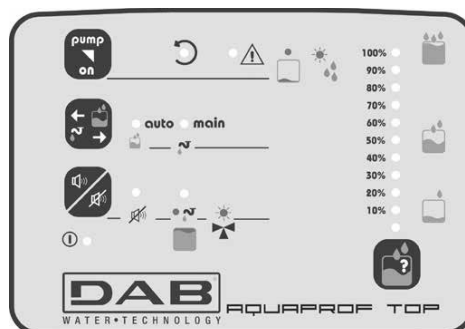

AQUAPROF TOP

### INSTALLATION DIAGRAM AQUAPROF BASIC AND TOP

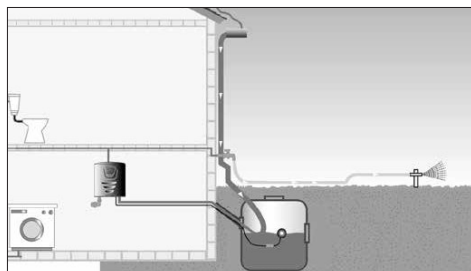

## AQUAPROF - PLANTS FOR USE OF RAINWATER

Liquid temperature range pumped: from +5 °C to +35 °C - Maximum ambient temperature: +40°C

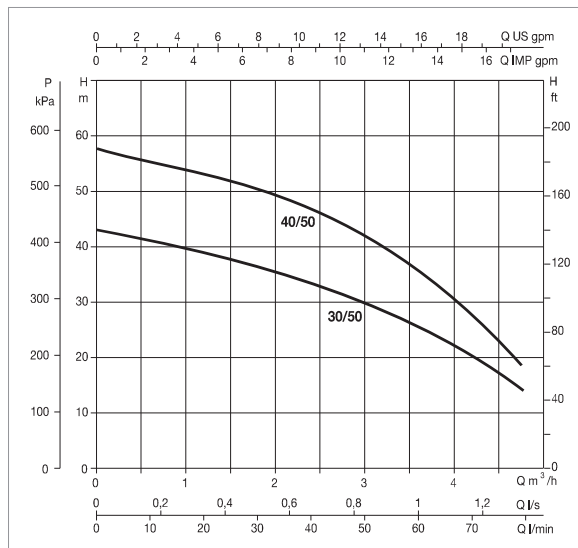
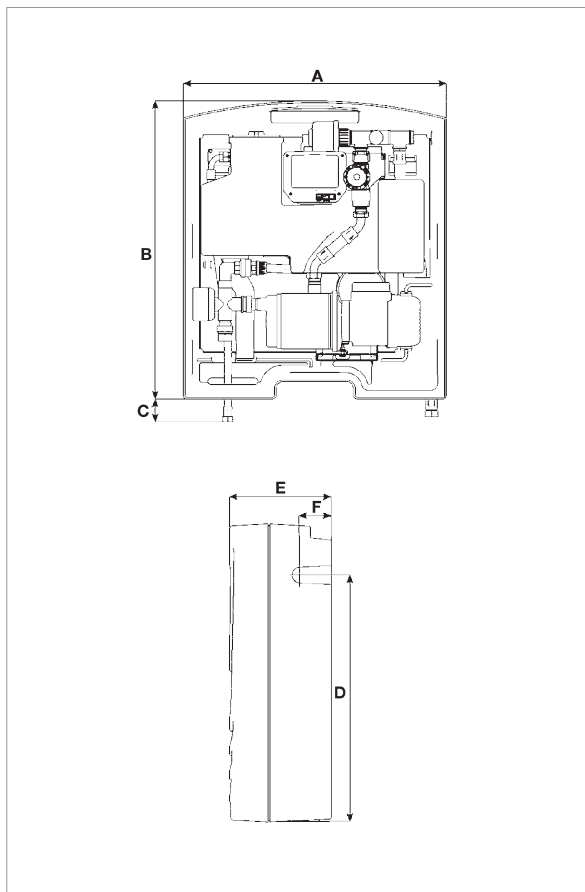

The performance curves are based on the kinematic viscosity values = 1 mm<sup>2</sup>/s and density equivalent to 1000 kg/m<sup>3</sup>. Curve tolerance according to ISO 9906.

MODEL	N° IMPELLER	POWER SUPPLY 50 Hz	P1 MAX KW	ELECTRICAL DATA		In A	CAPACITOR	
				P2 NOMINAL			μF	Vc
				kW	HP			
AQUAPROF BASIC 30/50	3	1x220-240 V ~	0,88	0,55	0,75	3,9	12,5	450
AQUAPROF BASIC 40/50	4	1x220-240 V ~	1,2	0,75	1	5,3	20	450
AQUAPROF TOP 30/50	3	1x220-240 V ~	0,88	0,55	0,75	3,9	12,5	450
AQUAPROF TOP 40/50	4	1x220-240 V ~	1,2	0,75	1	5,3	20	450

MODEL	A	B	C	D	E	F	GROSS WEIGHT Kg
AQUAPROF BASIC 30/50	750	850	50,5	747	290	148	28
AQUAPROF BASIC 40/50	750	850	50,5	747	290	148	32
AQUAPROF TOP 30/50	750	850	50,5	747	290	148	28
AQUAPROF TOP 40/50	750	850	50,5	747	290	148	32

**DAB**  
PUMPS SELECTOR

On-line product selection



**DAB PUMPS LTD.**  
6 Gilberd Court  
Newcomen Way  
Severalls Business Park  
Colchester  
Essex  
CO4 9WN - UK  
salesuk@dwgroup.com  
Tel. +44 0333 777 5010



**DAB PUMPS IBERICA S.L.**  
Calle Verano 18-20-22  
28850 - Torrejón de Ardoz - Madrid  
Spain  
Info.spain@dwgroup.com  
Tel. +34 91 6569545  
Fax: + 34 91 6569676



**DAB PUMPS SOUTH AFRICA (PTY) LTD**  
Twenty One Industrial Estate,  
16 Purlin Street, Unit B, Warehouse 4  
Ollifantsfontein - 1666 - South Africa  
info.sa@dwgroup.com  
Tel. +27 12 361 3997



**DAB PUMPS BV**  
"Hofveld 6 C1  
1702 Groot Bijgaarden - Belgium  
info.belgium@dwgroup.com  
Tel. +32 2 4668353



**DAB PUMPS HUNGARY KFT.**  
H-8800  
Nagykanizsa, Buda Ernő u.5  
Hungary  
Tel. +36 93501700



**DAB PUMPS (QINGDAO) CO, LTD.**  
No.40 Kaituo Road, Qingdao Economic & Technological  
Development Zone  
Qingdao City, Shandong Province - China  
PC: 266500  
sales.cn@dwgroup.com  
Tel. +86 400 186 8280  
Fax +86 53286812210



**DAB PUMPS B.V.**  
Albert Einsteinweg, 4  
5151 DL Drunen - Nederland  
info.netherlands@dwgroup.com  
Tel. +31 416 387280  
Fax +31 416 387299



**DAB PUMPS POLAND Sp. z o.o.**  
Ul. Janka Muzykanta 60  
02-188 Warszawa - Poland  
polska@dabpumps.com.pl



**DAB PUMPS DE MÉXICO, S.A. DE C.V.**  
Av Amsterdam 101 Local 4  
Col. Hipódromo Condesa,  
Del. Cuauhtémoc CP 06170  
Ciudad de México  
Tel. +52 55 6719 0493



**DAB PUMPS GMBH**  
Am Nordpark 3  
D - 41069 Mönchengladbach - Germany  
info.germany@dwgroup.com  
Tel. +49 2161 47388-0  
Fax +49 2161 47388-36



**OOO DAB PUMPS**  
Novgorodskaya str. 1, block G  
office 308, 127247, Moscow - Russia  
info.russia@dwgroup.com  
Tel. +7 495 122 0035  
Fax +7 495 122 0036



**DAB PUMPS OCEANIA PTY LTD**  
426 South Gippsland Hwy,  
Dandenong South VIC 3175 - Australia  
info.oceania@dwgroup.com  
Tel. +61 1300 373 677



**DAB PUMPS INC.**  
3226 Benchmark Drive  
Ladson, SC 29456 - USA  
info.usa@dwgroup.com  
Tel. 1- 843-797-5002  
Fax 1-843-797-3366



**PT DAB PUMPS INDONESIA**  
Satrio Tower lantai 26  
unit C-D, Jl. Prof. Dr. Satrio Kav. C4,  
Kel. Kuningan Timur, Kec. Setiabudi, Kota Adm.  
Jakarta Selatan, Prov. DKI Jakarta. - Indonesia  
Tel. +62 2129222850