

CENTRIFUGAL PUMPS

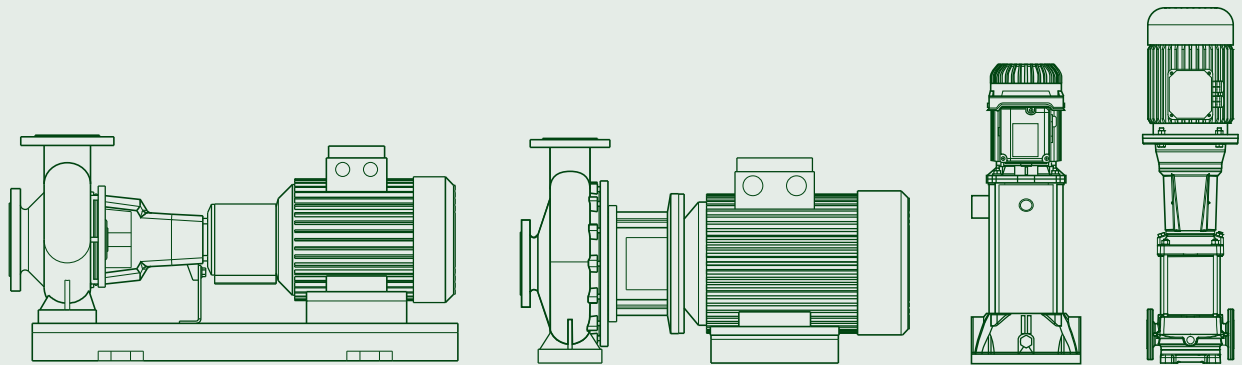

**TECHNICAL
CATALOGUE**

K TWIN-IMPELLER

TWIN-IMPELLER PUMPS

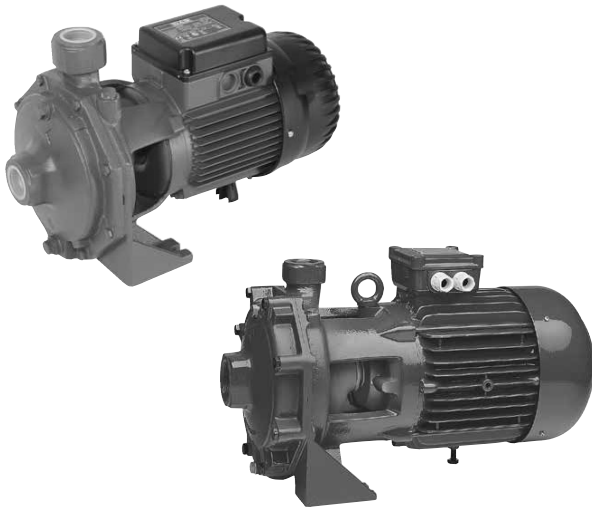

TECHNICAL DATA

Operating range:

from 1,2 to 30 m³/h with head up to 97 metres

Pumped liquid: clean, free of solids and abrasives, non-viscous, non-aggressive, non-crystallised and chemically neutral, with properties similar to water

Liquid temperature range:

K 35/40, K 45/50, K 35/100, K 40/100, K 55/100 :from -10 °C to +50 °C

K 55/50, K 66/100, K 90/100, K 70/300, K 80/300, K 70/400, K 80/400 :from -15 °C to +110 °C

Maximum ambient temperature: +40°C

Maximum operating pressure:

K 35/40, K 35/100, K 40/100 :6 bar (600 kPa)

K 45/50, K 55/50 :8 bar (800 kPa)

K 55/100, K 66/100 :10 bar (1000 kPa)

K 90/100, K 70/300, K 80/300, K 70/400, K 80/400 :12 bar (1200 kPa)

Protection class:

IP 55, IP 44 per K 35/40, K 45/50, K 55/50, K 35/100, K 40/100

Protection class at the terminal board: IP 55

Insulation class: F

Standard voltage:

single-phase 220-240 V / 50 Hz

three-phase 230-400 V / 50 Hz up to 4 kW included - 400 V 50 Hz from 5,5 kW

Installation: fixed, horizontal or vertical position, provided that the motor is always above the pump.

Special executions on requests: alternative voltages and frequencies.

APPLICATIONS

Twin-impeller centrifugal pump designed for the realisation of pressurization units in water systems and filling of pressure vessels.

Suitable for sprinkler systems and other general water supply uses.

CONSTRUCTION FEATURES OF THE PUMP

Pump body and motor support in cast iron.

Technopolymer impeller.

Carbon/ceramic mechanical seal.

CONSTRUCTION FEATURES OF THE MOTOR

Closed asynchronous type, external ventilation cooling.

Rotor running on permanently lubricated ball bearings, oversized to ensure low noise and durability.

Standard built-in thermo-amperometric protection. Capacitor permanently fitted on single phase versions.

For the protection of the three-phase motor, we recommend the use of remote overload cut-outs, in compliance with current local regulations.

Construction according to CEI 2-3.

IE2 motors as standard, from 0,75 kW to 5,5 kW - IE3 \geq 7,5 kW.

K TWIN-IMPELLER

TWIN-IMPELLER PUMPS

MATERIALS

No.	PARTS*	MATERIALS	MODELS
1	PUMP BODY	CAST IRON 200 UNI ISO 185	
3	SUPPORT	CAST IRON 200 UNI ISO 185	
4	IMPELLER	TECHNOPOLYMER A	K 35/40; K 45/50; K 35/100; K 40/100; K 55/100
		TECHNOPOLYMER B	K 55/50; K 66/100; K 90/100; K 70/300; K 80/300; K 70/400; K 80/400
7	SHAFT WITH ROTOR	AISI 416 STAINLESS STEEL X12CRS13 UNI 6900/71	K 35/40
		AISI 303 STAINLESS STEEL X10CRNIS 1089 UNI 6900/71	K 45/50; K 55/50; K 35/100; K 40/100; K 55/100; K66/100; K 90/100
		AISI 304 STAINLESS STEEL X5 1810 UNI 6900/71	K 70/300; K 80/300; K 70/400; K 80/400
16	MECHANICAL SEAL	CARBON / CERAMIC	
28	GASKET	NBR RUBBER	K 35/40; K 45/50; K 55/50; K 55/100; K 35/100; K 40/100
		GUARNITAL	K 66/100; K 90/100; K 70/300; K 80/300; K 70/400; K 80/400
34	INTERMEDIATE DISC	CAST IRON 200 UNI ISO 185	K 35/40; K 45/50; K 55/50; K 55/100; K 66/100; K 90/100; K 70/300; K 70/400; K 80/300; K 80/400

* In contact with the liquid

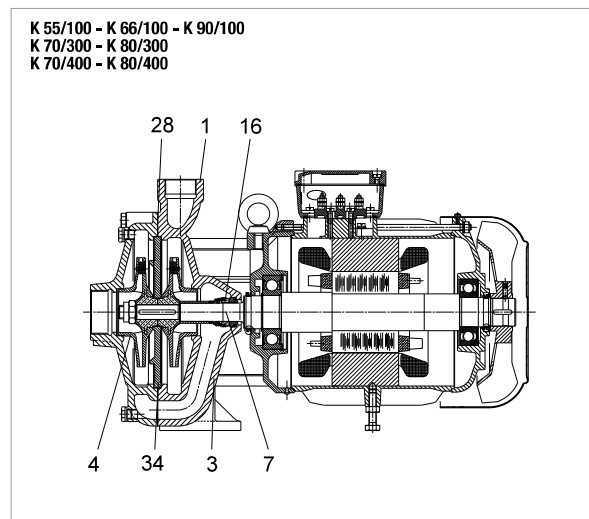
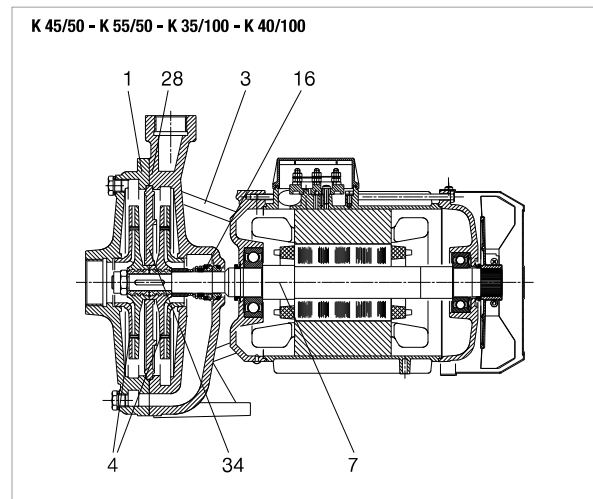
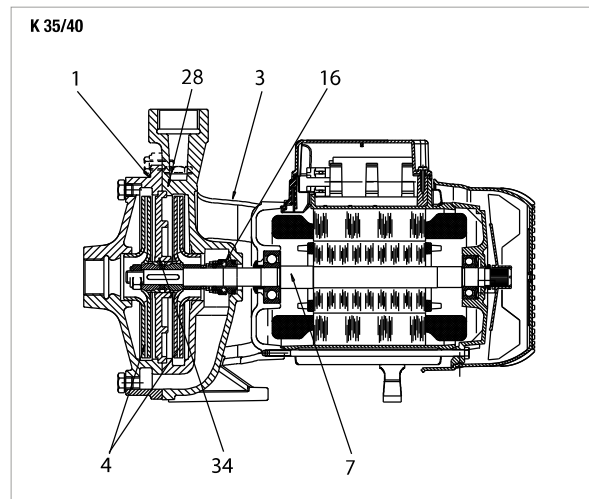

K TWIN-IMPELLER RANGE

ELECTRIC PUMPS

PERFORMANCE RANGE

The performance curves are based on kinematic viscosity values = 1 mm²/s and density equal to 1000 kg/m³. Curve tolerance according to ISO 9906.

GRAPHIC SELECTION TABLE

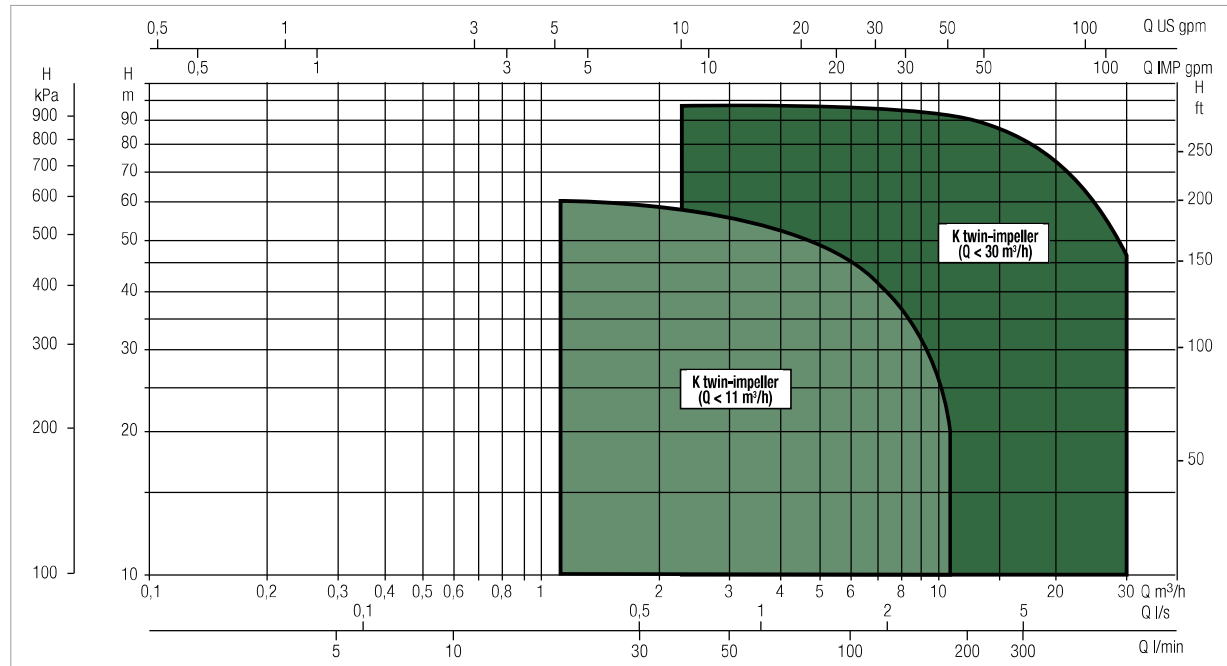

SELECTION TABLE

MODEL	Q=															
	0	1,2	1,8	2,4	3,6	4,8	6	7,2	9	9,6	10,8	12	15	18	24	30
	Q=															
	0	20	30	40	60	80	100	120	150	160	180	200	250	300	400	500
	H (m)															
K 35/40 M - T	43,5	41,5	40	38	33	23,5										
K 45/50 M - T	51	49	47,5	46	42	37	30									
K 55/50 M - T	62	60	58	57	52	45	34									
K 35/100 M - T	38,5			37,5	36,5	35	32	28,5	18,5	17,5						
K 40/100 M - T	44			43,4	42,5	41	39	35,7	29	26	18,5					
K 55/100 M - T	62			59,5	57	54,5	51	47	39	36						
K 66/100 M - T	73			70	67,5	64	60,5	57	49	47						
K 90/100 M - T	83,5			82	79,5	76,5	72,5	68	61	58						
K 70/300 T	76						74	73	72	71,5	70	69	65	60,5	43,5	
K 80/300 T	95						93	92,2	91	90,5	90	89,5	87	82	68	
K 70/400 T	86								84	83,2	82,5	82	79	76	65	47
K 80/400 T	97									95	94,5	94	92	89	80	64

K 35/40 - TWIN-IMPELLER PUMPS

Pumped liquid temperature range: from -10 °C to +50°C - Maximum ambient temperature: +40°C

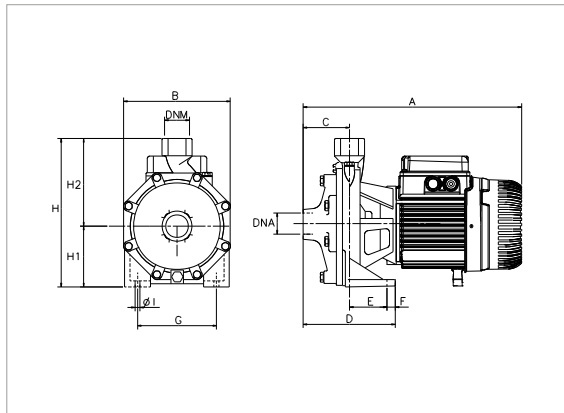

The performance curves are based on kinematic viscosity values = 1 mm²/s and density equal to 1000 kg/m³. Curve tolerance according to ISO 9906.

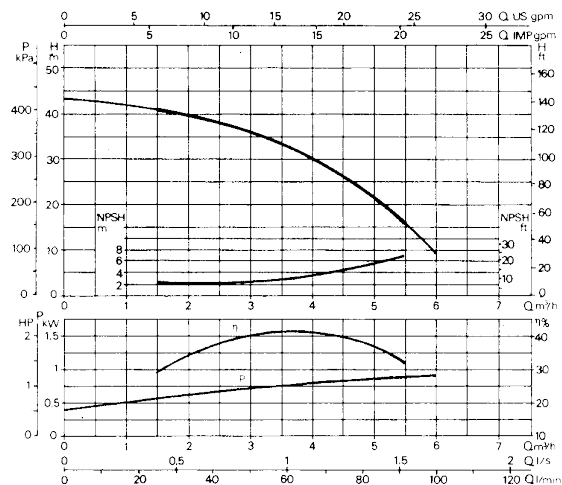

MODEL	POWER INPUT 50 Hz	P1 MAX kW	P2 NOMINAL		In A	MOTOR TYPE	Ist A	rpm n. 1/min.	CAPACITOR	
			kW	HP					μF	Vc
K 35/40 M	1 x 220 - 240 V ~	1,2	0,75	1	5,5	-	20	2800	20	450
K 35/40 T	3 x 230 - 400 V ~	1,1	0,75	1	3,6/2,1	IE3	15,2	2850	-	-
K 35/40 T	3 x 230 - 400 V ~	1,2	0,75	1	3,8/2,2	IE2	22,14-12,8	2850	-	-

MODEL	MOTOR TYPE	A	B	C	D	E	F	G	ØI	H	H1	H2	DNA	DNM	PACKING DIMENSIONS			VOLUME (m ³)	WEIGHT kg
															L/A	L/B	H		
K 35/40 M	-	342	180	76	148	72	15	148	9,5	235	100	135	1" G	1" G	392	232	262	0,024	15,9
K 35/40 T	IE3	342	180	76	148	72	15	148	9,5	235	100	135	1" G	1" G	392	232	262	0,024	15
K 35/40 T	IE2	342	180	76	148	72	15	148	9,5	235	100	135	1" G	1" G	392	232	262	0,024	15

K 45/50 - TWIN-IMPELLER PUMPS

Pumped liquid temperature range: from -10 °C to +50°C - Maximum ambient temperature: +40°C

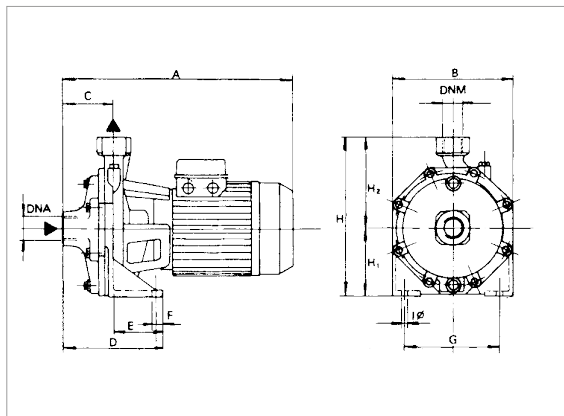

The performance curves are based on kinematic viscosity values = 1 mm²/s and density equal to 1000 kg/m³. Curve tolerance according to ISO 9906.

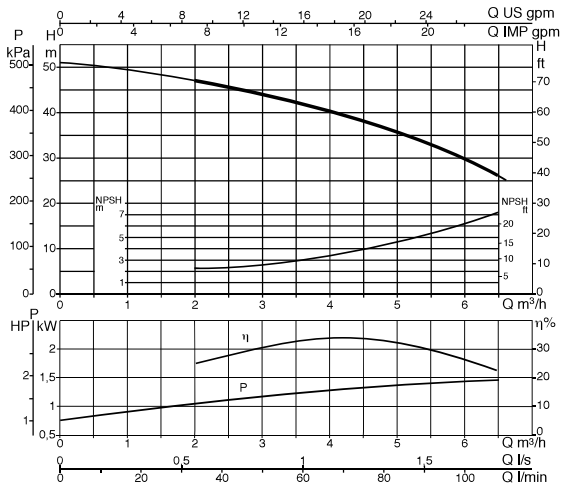

MODEL	POWER INPUT 50 Hz	P1 MAX kW	P2 NOMINAL		In A	MOTOR TYPE	Ist A	rpm n. 1/min.	CAPACITOR	
			kW	HP					μF	Vc
K 45/50 M	1 x 220 - 240 V ~	1,86	1,1	1,5	8,3	-	29	2800	31,5	450
K 45/50 T	3 x 230 - 400 V ~	1,8	1,1	1,5	5,9/3,4	IE3	26,9	2850	-	-
K 45/50 T	3 x 230 - 400 V ~	2	1,1	1,5	7,2/4	IE2	31,1-18	2850	-	-

MODEL	MOTOR TYPE	A	B	C	D	E	F	G	ØI	H	H1	H2	DNA	DNM	PACKING DIMENSIONS			VOLUME (m ³)	WEIGHT kg
															L/A	L/B	H		
K 45/50 M	-	370	210	75	144	69	15	165	11,5	268	118	150	1 1/2" G	1" G	415	234	295	0,028	23,3
K 45/50 T	IE3	370	210	75	144	69	15	165	11,5	268	118	150	1 1/2" G	1" G	415	234	295	0,028	22,5
K 45/50 T	IE2	370	210	75	144	69	15	165	11,5	268	118	150	1 1/2" G	1" G	415	234	295	0,028	22,5

K 55/50 - TWIN-IMPELLER PUMPS

Pumped liquid temperature range: from -15 °C to +110 °C - Maximum ambient temperature: +40°C

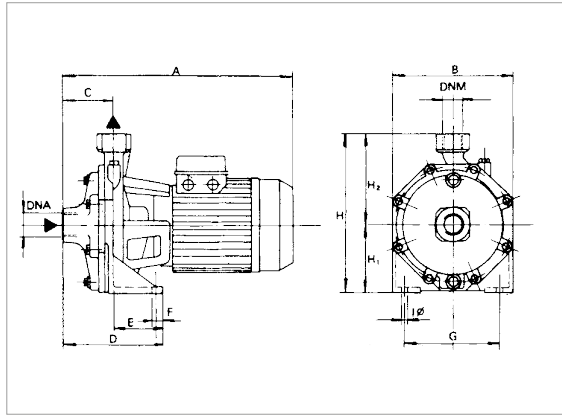

The performance curves are based on kinematic viscosity values = 1 mm²/s and density equal to 1000 kg/m³. Curve tolerance according to ISO 9906.

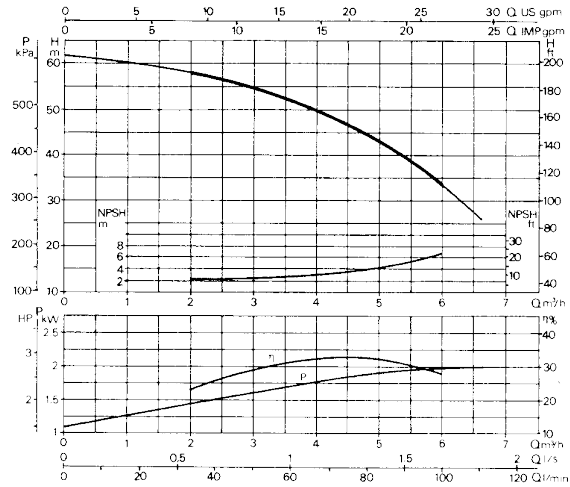

MODEL	POWER INPUT 50 Hz	P1 MAX kW	P2 NOMINAL		In A	MOTOR TYPE	Ist A	rpm n. 1/min.	CAPACITOR	
			kW	HP					μF	Vc
K 55/50 M	1 x 220 - 240 V ~	2,7	1,85	2,5	12,8	-	48	2850	40	450
K 55/50 T	3 x 220 - 400 V ~	2,4	1,85	2,5	7,4/4,3	IE3	26,4	2850	-	-
K 55/50 T	3 x 230 - 400 V ~	2,5	1,85	2,5	8,4-4,8	IE2	37,6-21,7	2850	-	-

MODEL	MOTOR TYPE	A	B	C	D	E	F	G	ØI	H	H1	H2	DNA	DNM	PACKING DIMENSIONS			VOLUME (m ³)	WEIGHT kg
															L/A	L/B	H		
K 55/50 M	-	370	210	75	144	69	15	165	11,5	268	118	150	1 1/2" G	1" G	415	234	295	0,032	27,2
K 55/50 T	IE3	370	210	75	144	69	15	165	11,5	268	118	150	1 1/2" G	1" G	415	234	295	0,032	23,9
K 55/50 T	IE2	370	210	75	144	69	15	165	11,5	268	118	150	1 1/2" G	1" G	415	234	295	0,032	23,9

K 35/100 - TWIN-IMPELLER PUMPS

Pumped liquid temperature range: from -10 °C to +50°C - Maximum ambient temperature: +40°C

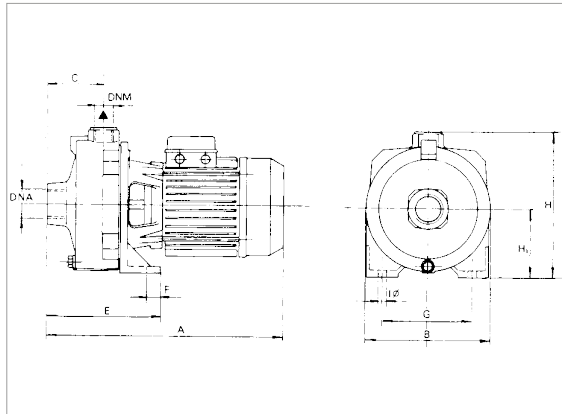

The performance curves are based on kinematic viscosity values = 1 mm²/s and density equal to 1000 kg/m³. Curve tolerance according to ISO 9906.

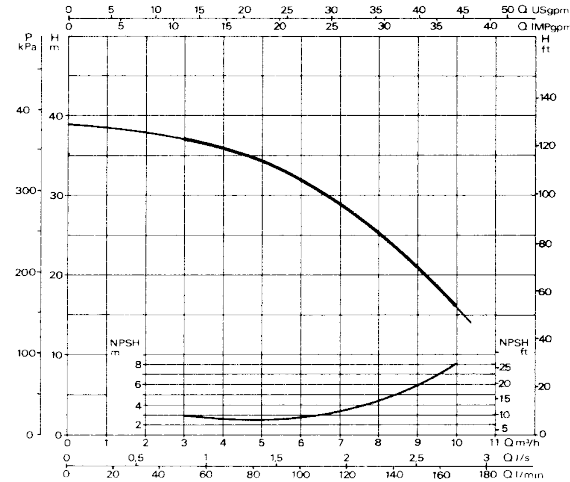

MODEL	POWER INPUT 50 Hz	P1 MAX kW	P2 NOMINAL		In A	MOTOR TYPE	Ist A	rpm n. 1/min.	CAPACITOR	
			kW	HP					μF	Vc
K 35/100 M	1 x 220 - 240 V ~	1,56	1,1	1,5	7,1	-	33	2780	25	450
K 35/100 T	3 x 230 - 400 V ~	1,6	1,1	1,5	5,5/3,2	IE3	26,4	2850	-	-
K 35/100 T	3 x 230 - 400 V ~	1,65	1,1	1,5	6,5-3,5	IE2	28,9	2850	-	-

MODEL	MOTOR TYPE	A	B	C	E	F	G	ØI	H	H1	DNA	DNM	PACKING DIMENSIONS			VOLUME (m ³)	WEIGHT kg
													L/A	L/B	H		
K 35/100 M	-	387	205	88	169	20	145	11	233	108	1 1/2" G	1" G	415	234	295	0,028	22
K 35/100 T	IE3	387	205	88	169	20	145	11	233	108	1 1/2" G	1" G	415	234	295	0,028	21
K 35/100 T	IE2	387	205	88	169	20	145	11	233	108	1 1/2" G	1" G	415	234	295	0,028	21

K 40/100 - TWIN-IMPELLER PUMPS

Pumped liquid temperature range: from -10°C to 50°C - Maximum ambient temperature: +40°C

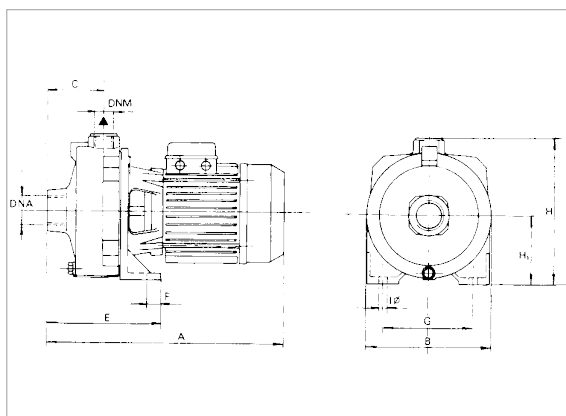

The performance curves are based on kinematic viscosity values = 1 mm²/s and density equal to 1000 kg/m³. Curve tolerance according to ISO 9906.

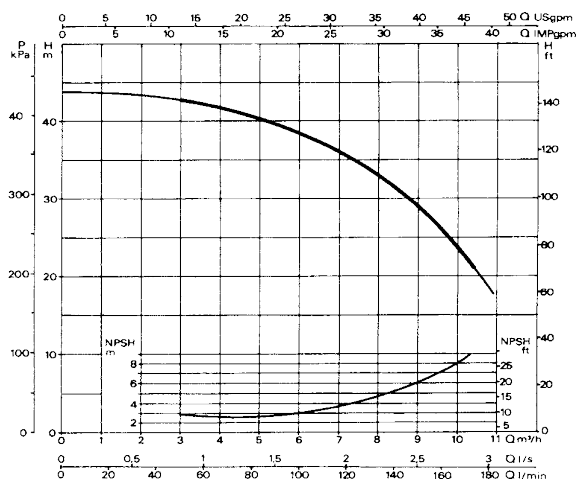

MODEL	POWER INPUT 50 Hz	P1 MAX KW	P2 NOMINAL		In A	MOTOR TYPE	Ist A	rpm n. 1/min.	CAPACITOR	
			kW	HP					μF	Vc
K 40/100 M	1 x 220 - 240 V ~	2	1,85	2,5	9	-	45	2850	40	450
K 40/100 T	3 x 230 - 400 V ~	1,8	1,85	2,5	6/3,5	IE3	26,4	2850	-	-
K 40/100 T	3 x 230 - 400 V ~	2	1,85	2,5	7/4	IE2	28,9	2850	-	-

MODEL	MOTOR TYPE	A	B	C	D	E	F	G	ØI	H	H1	DNA	DNM	PACKING DIMENSIONS			VOLUME (m ³)	WEIGHT kg
														L/A	L/B	H		
K 40/100 M	-	461	205	88	179	20	20	145	11	233	108	1 1/2" G	1" G	510	234	285	0,034	25,9
K 40/100 T	IE3	387	205	88	179	20	20	145	11	233	108	1 1/2" G	1" G	415	234	285	0,028	22
K 40/100 T	IE2	387	205	88	179	20	20	145	11	233	108	1 1/2" G	1" G	415	234	295	0,028	22

K 55/100 - TWIN-IMPELLER PUMPS

Pumped liquid temperature range: from -10 °C to +50°C - Maximum ambient temperature: +40°C

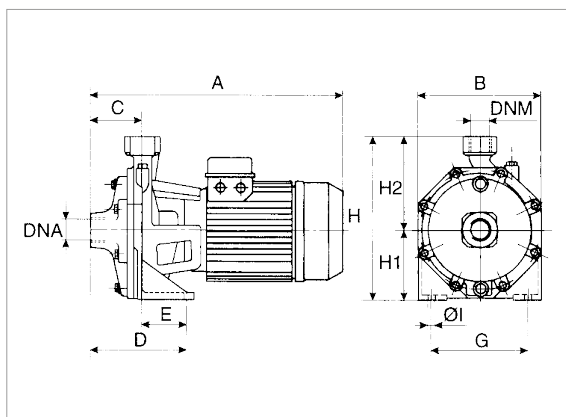

The performance curves are based on kinematic viscosity values = 1 mm²/s and density equal to 1000 kg/m³. Curve tolerance according to ISO 9906.

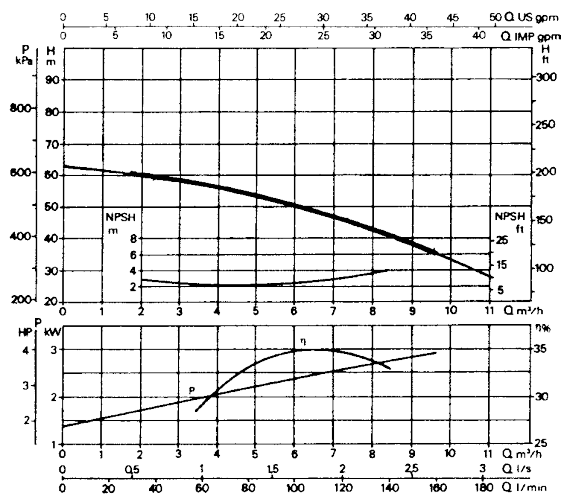

MODEL	POWER INPUT 50 Hz	P1 MAX KW	P2 NOMINAL		In A	MOTOR TYPE	Ist A	rpm n. 1/min.	CAPACITOR	
			kW	HP					μF	Vc
K 55/100 M	1 x 220 - 240 V ~	3,4	2,2	3	14,9	-	50	2900	80	450
K 55/100 T	3 x 230 - 400 V ~	3,7	2,2	3	11,4/6,6	IE3	44,2	2850	-	-
K 55/100 T	3 x 230 - 400 V ~	3,9	2,2	3	13,7/7,9	IE2	67,5-39	2850	-	-

MODEL	MOTOR TYPE	A	B	C	D	E	F	G	ØI	H	H1	H2	DNA	DNM	PACKING DIMENSIONS			VOLUME (m ³)	WEIGHT kg
															L/A	L/B	H		
K 55/100 M	-	450	256	88	160	72	18	200	14	312,5	140	172,5	1 1/2" G	1" G	500	274	333	0,045	40
K 55/100 T	IE3	450	256	88	160	72	18	200	14	312,5	140	172,5	1 1/2" G	1" G	500	274	333	0,045	19
K 55/100 T	IE2	450	256	88	160	72	18	200	14	312,5	140	172,5	1 1/2" G	1" G	500	274	333	0,045	38,1

K 66/100 - TWIN-IMPELLER PUMPS

Pumped liquid temperature range: from -15 °C to +110 °C - Maximum ambient temperature: +40°C

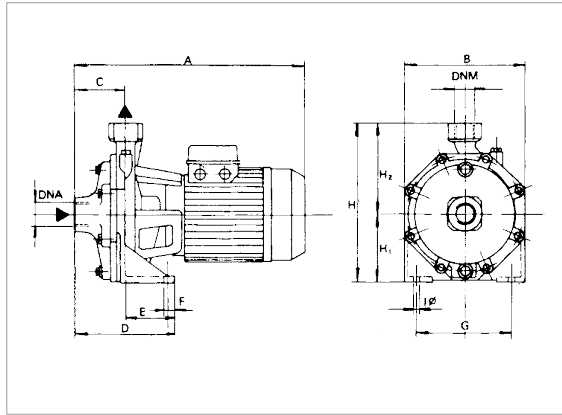

The performance curves are based on kinematic viscosity values = 1 mm²/s and density equal to 1000 kg/m³. Curve tolerance according to ISO 9906.

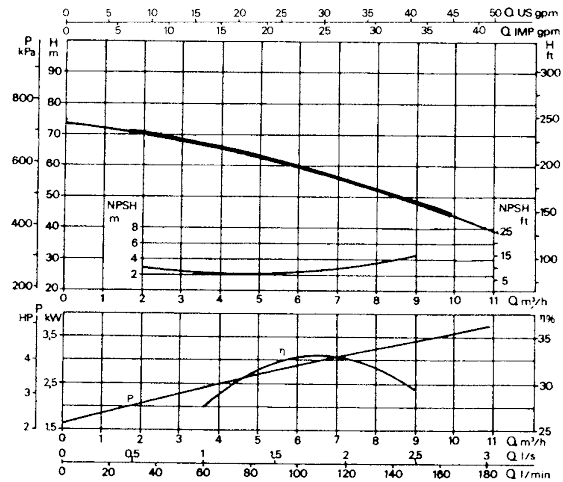

MODEL	POWER INPUT 50 Hz	P1 MAX kW	P2 NOMINAL		In A	MOTOR TYPE	Ist A	rpm n. 1/min.	CAPACITOR	
			kW	HP					μF	Vc
K 66/100 M	1 x 220 - 240 V ~	4,4	3	4	19,5	-	80	2900	160	450
K 66/100 T	3 x 230 - 400 V ~	4,7	3,7	5	14,7/8,5	IE3	51,6	2850	-	-
K 66/100 T	3 x 230 - 400 V ~	4,7	3	4	14,6/8,4	IE2	103,8-60	2850	-	-

MODEL	MOTOR TYPE	A	B	C	D	E	F	G	ØI	H	H1	H2	DNA	DNM	PACKING DIMENSIONS			VOLUME (m ³)	WEIGHT Kg
															L/A	L/B	H		
K 66/100 M	-	450	256	88	160	72	18	200	14	312,5	140	172,5	1½" G	1" G	500	274	333	0,045	44
K 66/100 T	IE3	450	256	88	160	72	18	200	14	312,5	140	172,5	1½" G	1" G	500	274	333	0,045	40,7
K 66/100 T	IE2	450	256	88	160	72	18	200	14	312,5	140	172,5	1½" G	1" G	500	274	333	0,045	40,7

K 90/100 - TWIN-IMPELLER PUMPS

Pumped liquid temperature range: from -15°C to +110°C - Maximum ambient temperature: +40°C

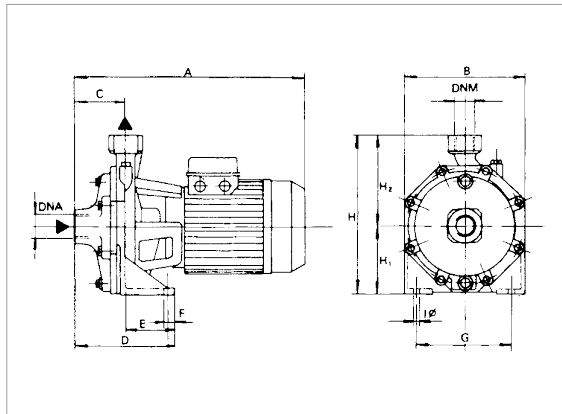

The performance curves are based on kinematic viscosity values = 1 mm²/s and density equal to 1000 kg/m³. Curve tolerance according to ISO 9906.

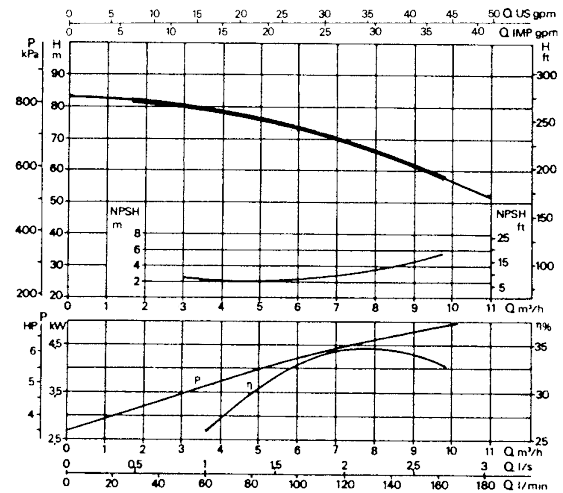

MODEL	POWER INPUT 50 Hz	P1 MAX kW	P2 NOMINAL		In A	MOTOR TYPE	Ist A	rpm n. 1/min.	CAPACITOR	
			kW	HP					μF	Vc
K 90/100 M	1 x 220 - 240 V ~	5	4	5,5	21,9	-	110	2900	160	450
K 90/100 T	3 x 230 - 400 V ~	5,6	3,7	5	16,8/9,7	IE3	51,6	2850	-	-
K 90/100 T	3 x 230 - 400 V ~	5,4	4	5,5	16,5/9,5	IE2	103,8-60	2850	-	-

MODEL	MOTOR TYPE	A	B	C	D	E	F	G	ØI	H	H1	H2	DNA	DNM	PACKING DIMENSIONS			VOLUME (m ³)	WEIGHT Kg
															L/A	L/B	H		
K 90/100 M	-	450	256	88	160	72	18	200	14	312,5	140	172,5	1½" G	1" G	500	274	333	0,045	46
K 90/100 T	IE3	450	256	88	160	72	18	200	14	312,5	140	172,5	1½" G	1" G	500	274	333	0,045	44
K 90/100 T	IE2	450	256	88	160	72	18	200	14	312,5	140	172,5	1½" G	1" G	500	274	333	0,045	44

K 70/300 - TWIN-IMPELLER PUMPS

Pumped liquid temperature range: from -15 °C to +110 °C - Maximum ambient temperature: +40°C

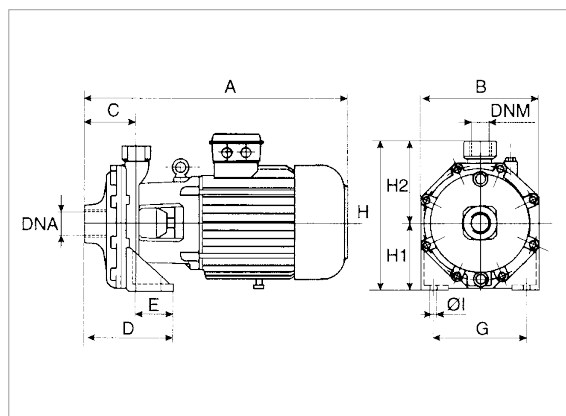

The performance curves are based on kinematic viscosity values = 1 mm²/s and density equal to 1000 kg/m³. Curve tolerance according to ISO 9906.

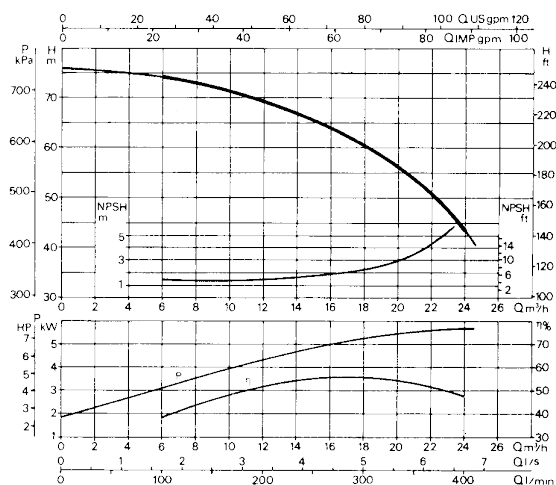

MODEL	ELECTRICAL DATA							
	POWER INPUT 50 Hz	P1 MAX kW	P2 NOMINAL		In A	MOTOR TYPE	Ist A	rpm n. 1/min.
			kW	HP				
K 70/300 T	3 x 400 V ~ ¹	6,9	5,5	7,5	11,6	IE3	77,9	2900

MODEL	A	B	C	D	E	F	G	ØI	H	H1	H2	DNA	DNM	PACKING DIMENSIONS			VOLUME (m ³)	WEIGHT Kg
														L/A	L/B	H		
K 70/300 T	595	270	122	182	60	20	210	14	340	160	180	2" G	1 1/4" G	680	330	470	0,106	72

¹ star starting is possible (A)

K 80/300 - TWIN-IMPELLER PUMPS

Pumped liquid temperature range: from -15 °C to +110 °C - Maximum ambient temperature: +40°C

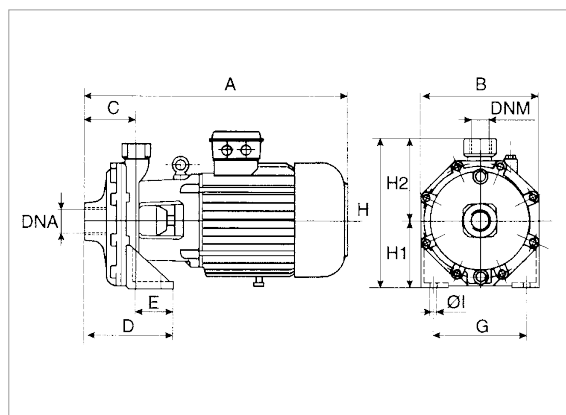

The performance curves are based on kinematic viscosity values = 1 mm²/s and density equal to 1000 kg/m³. Curve tolerance according to ISO 9906.

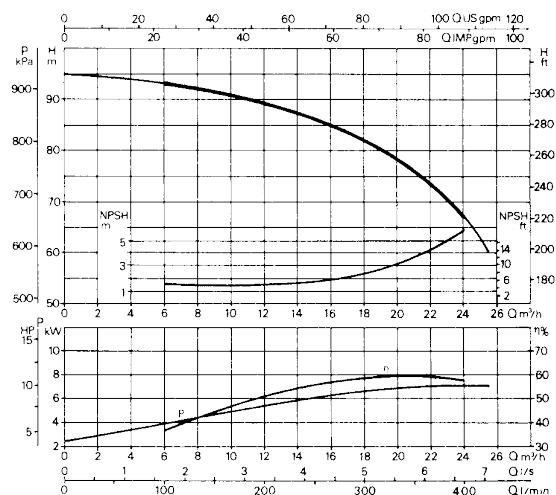

MODEL	ELECTRICAL DATA							
	POWER INPUT 50 Hz	P1 MAX kW	P2 NOMINAL		In A	MOTOR TYPE	Ist A	rpm n. 1/min.
			kW	HP				
K 80/300 T	3 x 400 V ~ ¹	9,1	7,5	10	15,2	IE3	112	2910

MODEL	A	B	C	D	E	F	G	ØI	H	H1	H2	DNA	DNM	PACKING DIMENSIONS			VOLUME (m ³)	WEIGHT Kg
														L/A	L/B	H		
K 80/300 T	595	270	122	182	60	20	210	14	340	160	180	2" G	1 1/4" G	680	330	470	0,106	78,5

¹ star starting is possible (A)

K 70/400 - TWIN-IMPELLER PUMPS

Pumped liquid temperature range: from -15 °C to +110 °C - Maximum ambient temperature: +40°C

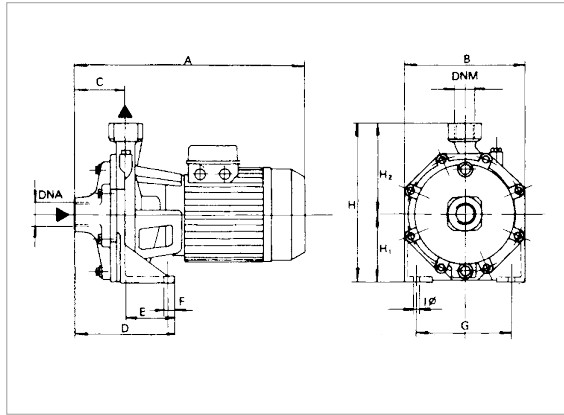

The performance curves are based on kinematic viscosity values = 1 mm²/s and density equal to 1000 kg/m³. Curve tolerance according to ISO 9906.

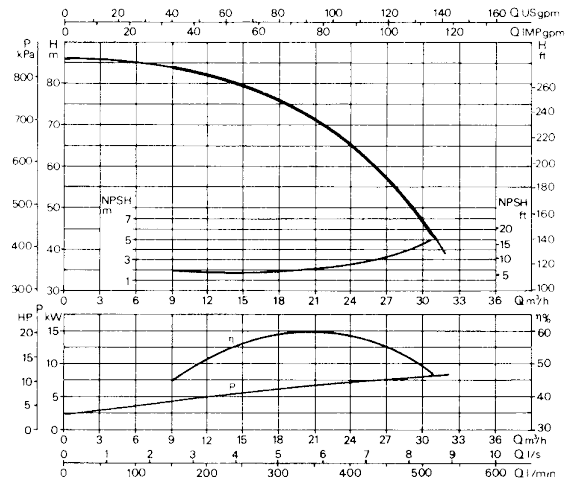

MODEL	ELECTRICAL DATA							
	POWER INPUT 50 Hz	P1 MAX kW	P2 NOMINAL		In A	MOTOR TYPE	Ist A	rpm n. 1/min.
			kW	HP				
K 70/400 T	3 x 400 V ~ 1	9,2	9,2	12,5	15,5	IE3	135	2930

MODEL	A	B	C	D	E	F	G	ØI	H	H1	H2	DNA	DNM	PACKING DIMENSIONS			VOLUME (m ³)	WEIGHT Kg
														L/A	L/B	H		
K 70/400 T	635	270	122	182	60	20	210	14	340	160	180	2" G	1 1/4" G	680	330	470	0,106	74

¹ star starting is possible (A)

K 80/400 - TWIN-IMPELLER PUMPS

Pumped liquid temperature range: from -15°C to +110°C - Maximum ambient temperature: +40°C

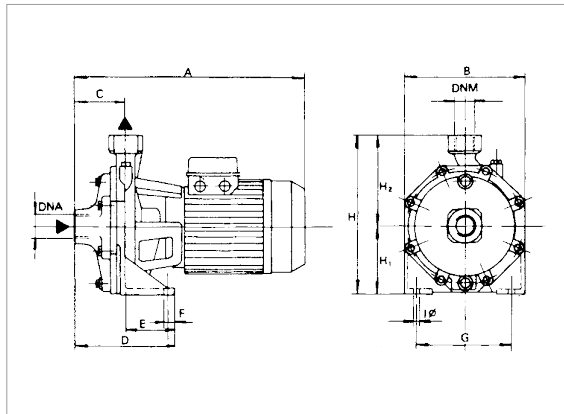

The performance curves are based on kinematic viscosity values = 1 mm²/s and density equal to 1000 kg/m³. Curve tolerance according to ISO 9906.

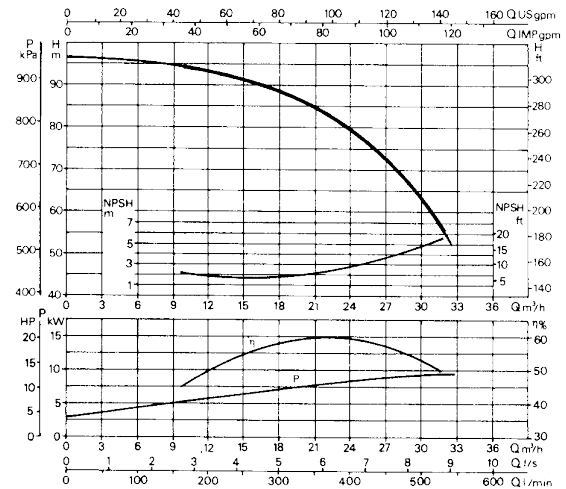

MODEL	ELECTRICAL DATA							
	POWER INPUT 50 Hz	P1 MAX kW	P2 NOMINAL		In A	MOTOR TYPE	Ist A	rpm n. 1/min.
			kW	HP				
K 80/400 T	3 x 400 V ~ 1	10,8	11	15	18,5	IE3	193	2940

MODEL	A	B	C	D	E	F	G	ØI	H	H1	H2	DNA	DNM	PACKING DIMENSIONS			VOLUME (m ³)	WEIGHT Kg
														L/A	L/B	H		
K 80/400 T	635	270	122	182	60	20	210	14	340	160	180	2" G	1 1/4" G	680	330	470	0,106	79

¹ star starting is possible (A)

DWA

PUMPS SELECTOR



On-line product selection



DAB PUMPS LTD.
6 Gilberd Court
Newcomen Way
Severalls Business Park
Colchester
Essex
CO4 9WN - UK
salesuk@dwtgroup.com
Tel. +44 0333 777 5010



DAB PUMPS IBERICA S.L.
Calle Verano 18-20-22
28850 - Torrejón de Ardoz - Madrid
Spain
Info.spain@dwtgroup.com
Tel. +34 91 6569545
Fax: + 34 91 6569676



DAB PUMPS SOUTH AFRICA (PTY) LTD
Twenty One Industrial Estate,
16 Purlin Street, Unit B, Warehouse 4
Olifantsfontein - 1666 - South Africa
info.sa@dwtgroup.com
Tel. +27 12 361 3997



DAB PUMPS BV
'tHofveld 6 C1
1702 Groot Bijgaarden - Belgium
info.belgium@dwtgroup.com
Tel. +32 2 4668353



DAB PUMPS HUNGARY KFT.
H-8800
Nagykanizsa, Buda Ernő u.5
Hungary
Tel. +36 93501700



DAB PUMPS (QINGDAO) CO. LTD.
No.40 Kaituo Road, Qingdao Economic & Technological
Development Zone
Qingdao City, Shandong Province - China
PC: 266500
sales.cn@dwtgroup.com
Tel. +86 400 186 8280
Fax +86 53286812210



DAB PUMPS B.V.
Albert Einsteinweg, 4
5151 DL Drunen - Nederland
info.netherlands@dwtgroup.com
Tel. +31 416 387280
Fax +31 416 387299



DAB PUMPS POLAND Sp. z o.o.
Ul. Janka Muzykanta 60
02-188 Warszawa - Poland
polska@dabpumps.com.pl



DAB PUMPS DE MÉXICO, S.A. DE C.V.
Av Amsterdam 101 Local 4
Col. Hipódromo Condesa,
Del. Cuauhtémoc CP 06170
Ciudad de México
Tel. +52 55 6719 0493



OOO DAB PUMPS
Novgorodskaya str. 1, block G
office 308, 127247, Moscow - Russia
info.russia@dwtgroup.com
Tel. +7 495 122 0035
Fax +7 495 122 0036



DAB PUMPEN DEUTSCHLAND GmbH
Tackweg 11
D - 47918 Tönisvorst - Germany
info.germany@dwtgroup.com
Tel. +49 2151 82136-0
Fax +49 2151 82136-36



DAB PUMPS INC.
3226 Benchmark Drive
Ladson, SC 29456 - USA
info.usa@dwtgroup.com
Tel. 1- 843-797-5002
Fax 1-843-797-3366



DAB PUMPS OCEANIA PTY LTD
426 South Gippsland Hwy,
Dandenong South VIC 3175 - Australia
info.oceania@dwtgroup.com
Tel. +61 1300 378 677